



# 54" Galvanized Slant Wall Fan

- ▶ Belt Driven
- ▶ 1725 RPM
- ▶ 1 HP Motor
- ▶ 120/240 V



#WS-54BDLA



## Slant Wall Shutter

Designed with a galvanized frame and aluminum shutters.



## Galvanized Metal Cone

Features perforated edges that allows fans to be installed closer to each other in retrofit applications, reducing the need to reframe each fan opening.

1-800-949-4647

[www.hogslat.com](http://www.hogslat.com)



World Leader in Swine Production Solutions





# 54" Galvanized Slant Wall Fan

## Rough Opening (Width x Height)

60 3/4" x 63 1/2"  
(154.3 cm x 161.3 cm)

## Fan Dimensions

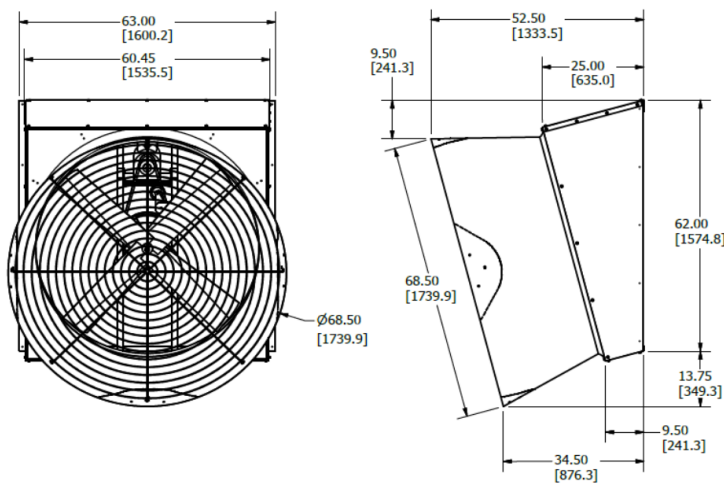

## Fan Spacing

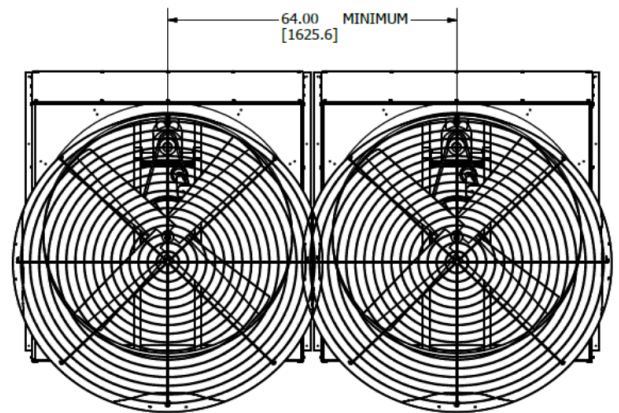

## Specifications for Windstorm 54" Galvanized Slant Wall Fan

Bess Test #14344 \*Performance shown with cone

| Model      | Static Pressure (in.H2O) | Airflow (cfm) | Rpm | Volts | Amps | Watts | cfm/Watt |
|------------|--------------------------|---------------|-----|-------|------|-------|----------|
| WS-54SBDLA | 0.00                     | 28400         | 475 | 231.6 | 5.56 | 1203  | 23.6     |
|            | 0.05                     | 27100         | 473 | 230.0 | 5.87 | 1261  | 21.5     |
|            | 0.10                     | 25400         | 471 | 229.6 | 6.17 | 1322  | 19.2     |
|            | 0.15                     | 23400         | 469 | 229.4 | 6.45 | 1381  | 16.9     |
|            | 0.20                     | 20400         | 467 | 231.4 | 6.71 | 1447  | 14.1     |
|            | 0.25                     | 17100         | 465 | 231.0 | 7.01 | 1510  | 11.3     |
|            | 0.30                     | 12200         | 462 | 229.0 | 7.28 | 1553  | 7.8      |

\*Tested by Bess Laboratories, University of Illinois

1-800-949-4647

www.hogslat.com

 World Leader in Swine Production Solutions

