

WS-36BDD Galvanized 36" Direct Drive Box Fan Installation and Operation Manual



Table of Contents

GrowerSELECT General Page.....3

Safety4

 Warning Labels4

 Installation5

 Operation Safety5

 Maintenance Safety5

Installation6

 Framing6

 Orientation.....7

 Pre-Operation Assessment.....7

Maintenance7

Performance.....8

Troubleshooting8

Exploded Diagrams9

Replacement Parts9

Hog Slat Limited Warranty..... 10

GrowerSELECT General Page

General Installation Notes:

Make sure that power is disconnected from system prior to servicing.

Installation of this equipment and related OEM equipment should be in accordance with these instructions, OEM's installation instructions and local codes (if applicable). Failure to follow specified instructions may cause damage to equipment and/or personal injury or death.

Take special note of any Warnings or Safety Decals on the equipment and in manuals.

Always wear protective clothing and any applicable Personal Protective Equipment (Safety Glasses and/or Ear Plugs) when working with the equipment.

Discarded materials, equipment and boxes should be recycled in accordance with local and national codes.

Safety Instructions:

Read all safety messages in this manual and on equipment safety decals. Follow recommended precautions and safe operating practices.

Ground all electrical equipment for safety.

Ground all non-current carrying metal parts to guard against electrical shock.

Always keep safety decals in good condition and replace missing or damaged decals.

Safety

Warning Labels

Warning Decals have been placed on the equipment to warn of potentially dangerous situations. Care should be taken to keep this information intact and easy to read at all times. Replace missing or damaged safety signs.

Safety–Alert Symbol

This is a safety–alert symbol. When you see this symbol on your equipment, be alert to the potential for personal injury. GrowerSelect equipment is designed to be installed and operated as safely as possible...however, hazards do exist.



Safety decals should be read and understood thoroughly by individuals within the local area of the fan. Safety decals should be visible from both the front and back of the fan. Should a decal be missing or damaged, please contact Hog Slat Inc. for a free replacement:

Hog Slat Inc.
 206 Fayetteville St.
 Newton Grove, NC 28366
 Toll Free: 800-949-4647
 Local: 910-594-0219

The below safety decal should be represented and visible on both the front and back sides of the fan. This label is identified by the HSLABEL-080 part number in the lower right corner.

WARNING – FLYING OBJECTS AND ROTATING PARTS

Ensure fan guards are in place during operation.
 Securely tighten propeller to shaft to avoid slipping.
 Disconnect power supply for inspection or service when guards are removed and personnel are exposed to propeller.

WARNING – HIGH VOLTAGE

Disconnect electrical power before inspecting or servicing equipment unless maintenance instructions specifically states otherwise.
 Ground all electrical equipment for safety.
 All electrical wiring must be done by a qualified electrician in accordance with local and national electrical codes.

Ground all non-current carrying metal parts to guard against electrical shock. With the exception of motor overload protection, electrical disconnects and over current protection are not supplied with the equipment.



Figure 1: HSLABEL-080 Warning Label

Installation

Prior to any installation, product should be inspected for any damage caused during shipping. Operation of a damaged fan could cause injury and further damage to the fan. Any damage found should be documented and communicated to liable parties.

Operation Safety

When the fan is in operation, no attempt should be made to service or interact with parts from the fan. Any attempt to interact with fan parts while the fan is operating could result in injury. Front and rear wire guards are in place to help prevent foreign objects from entering inside the outer perimeter of the housing. If maintenance to the fan is required, interrupt the source of power to the motor and allow propeller to stop spinning completely before moving forward with any efforts to service.

Maintenance Safety

Wind Storm Fans are designed and built with operator safety in mind. Some safeguards must be disassembled or removed for the parts to be serviced or replaced. As this fan does have moving parts and is supplied with electrical power, steps must be taken to ensure safety around these presented hazards.

READ THESE INSTRUCTIONS BEFORE SERVICE OR PART REPLACEMENT

1. Read and understand the operating manual before trying to install or operate Wind Storm Fans.
2. Power supply should be turned OFF and LOCKED OUT for service to motor and electrical components. Use **CAUTION** in checking voltage or other procedures requiring power to be ON.
3. DO NOT attempt to bypass any safety features or devices to operate the fan.
4. Keep fan clean of all debris that may collect the motor, prop, and any bearings, belts, or pulleys.
5. Use **CAUTION** in working around all moving parts of the fan.

Fan guards or shutters must be in place before fan can be safely started and operational.

Installation

IMPORTANT NOTE: THIS FAN SHOULD NOT BE INSTALLED IN A STATIC PRESSURE APPLICATION.

Framing

The rough in opening for the fan is an exact measurement that accounts for the heads of fasteners and openings for fan. Ensure there is proper clearance for installation or rough opening may require larger measurements.

Fan Model	Rough Opening (Width x Height)
36" Direct Drive Box Fan	40-1/2" x 40-1/2" (102.8 cm x 102.8 cm)

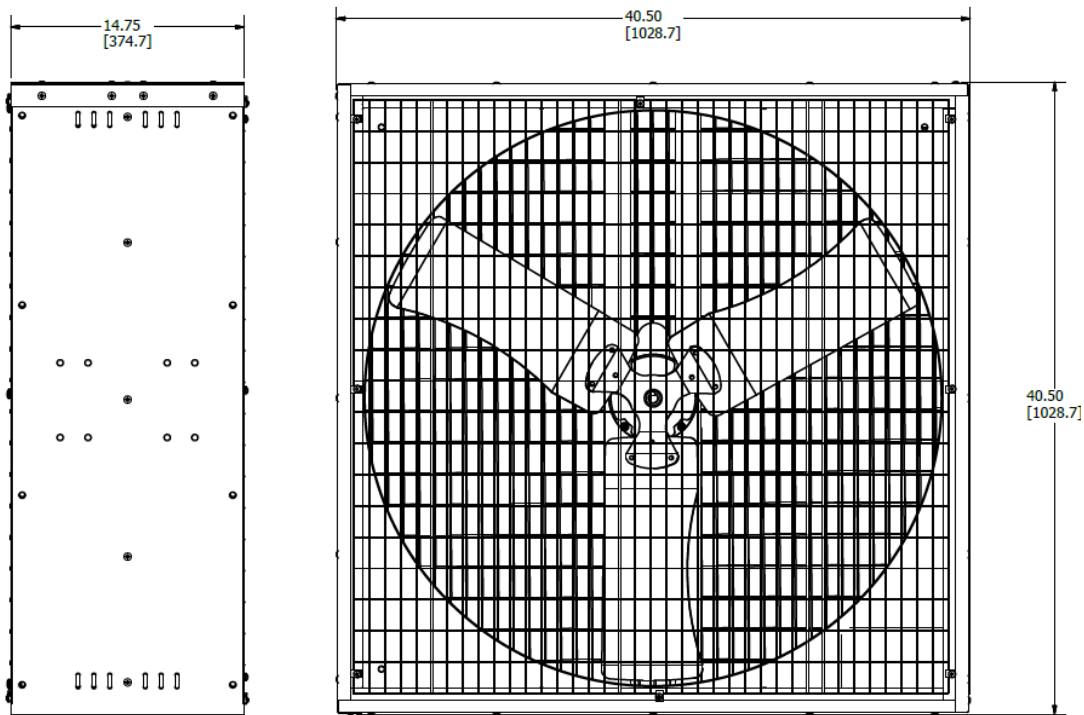

Figure 2: WS-36BDD Framing Dimensions

Orientation

When installed or used as a mobile unit to move free air, the fan must be oriented with the motor capacitor on top. Failure to do this may eventually lead to premature failure of the capacitor due to concentration of excessive moisture. The label on the right will be located on both sides of the fan venturi to ensure the fan is installed and/or operated in the correct orientation.



Figure 3: HSLABEL-347 Installation Orientation Label

Pre-Operation Assessment

Before beginning fan operation, please follow the below checklist to ensure that:

- ✓ Fan power cord securely connected to a good power supply.
- ✓ All safety labels are visible to personnel that will work in the area.
- ✓ Front and back wire guards are in place and secured to the fan housing.
- ✓ No foreign objects are protruding through the fan housing.

Maintenance

In order to begin any maintenance or service to the fan, power must be turned OFF and all moving parts must come to a complete STOP before accessing. All parts inside of the fan housing are accessed by removing the front and rear wire guard panels.

Once service is complete, clean excessive build-up from parts. Excessive dust and dirt on parts can cause vibration in the propeller and overheating of the motor. Before beginning operation again, ensure that all safeguards are back in place and all foreign objects are free from the area.

Performance

Hog Slat Inc. takes great pride in supplying our customers with fans that meet or exceed their performance needs. Our fan performance data is collected from production line fans to insure just that.

BESS LABS TEST NUMBER 16058 JANUARY 8, 2016

Thrust (lbf)	Thrust Efficiency Ratio (lbf/kW)	RPM	Volts	Amps	Watts	Airflow (thrust cfm)	Efficiency (thrust cfm/W)
9.05	17.7	858	230	2.65	.511	10200	20

Troubleshooting

Trouble	Possible Cause(s)	Corrective Action
Excessive noise	Worn motor bearing.	Replace
	Damage to fan blade	Replace prop
	Loose fasteners on motor or housing	Tighten fasteners
Excessive vibration	Fan blade is out of balance due to dirt build-up.	Clean entire unit
	Fan blade is out of balance due to damage	Replace prop
Insufficient airflow	Intake or exhaust guards clogged with debris	Clean entire unit
	Intake or exhaust blocked by foreign object	Remove object from airflow path
Fan won't operate	Open power supply circuit.	Check wiring and reset circuit breaker
	Defective motor	Reset motor, repair, or replace
Motor overheats and nuisance trips	Improper airflow due to clogged Inlet/Outlet	Clean entire unit
	Motor or Fan prop has excessive debris build-up	Clean entire unit

Exploded Diagrams

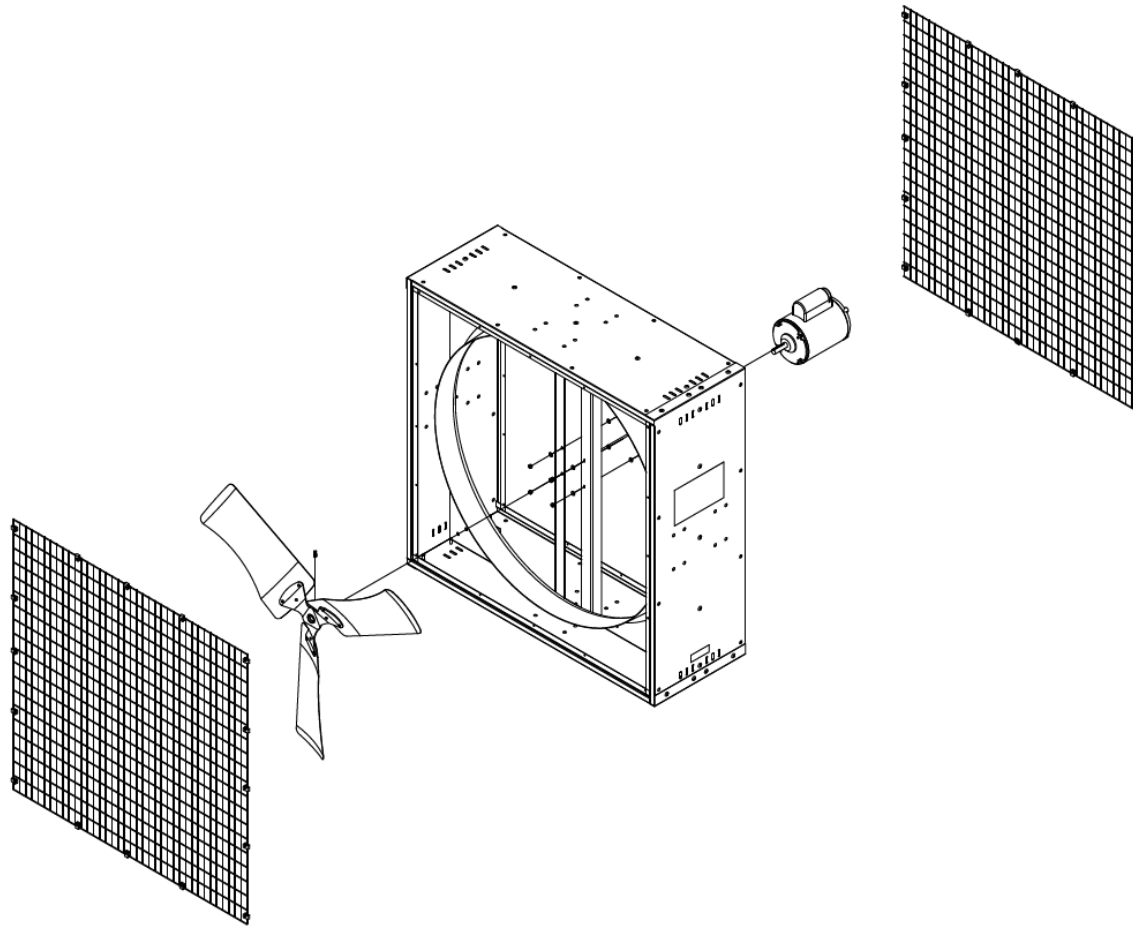

Figure 4: WS-36BDD Exploded View

Replacement Parts

Table 1: Replacement Parts List

Replacement Part Number	Description
HS9005A	Motor 1/2 HP 825 RPM 1 PH 115/230V 60/50 Hz
HS900-36D	Prop 36" Galvanized 3 Blade 0.625" Shaft OD
HSCS-002	Cord SJ 14/3 9' 220 V

For OSHA compliant guards, contact your local Hog Slat representative.

Hog Slat Limited Warranty

Hog Slat warrants products to be free from defects in material or workmanship for a period of twenty-four (24) months from the date of **original purchase**. Hog Slat will credit, repair, or replace, at its option any product deemed defective within this time period. Labor costs associated with the replacement or repair of the product are not covered by the Seller/Manufacturer.

Warranty Extension Coverage

The Limited Warranty period is extended for the following products:

Direct Drive Motor	3 Years (from the date of installation)
--------------------	---

Conditions and Limitations

1. The product must be installed by and operated in accordance with the instructions published by the **Seller/Manufacturer or Warranty will be void**. If this product is installed in a static pressure application, **Warranty will be void**.
2. Warranty is void if **all components** are not original equipment supplied by the **Seller/Manufacturer**.
3. This product must be purchased from and installed by an authorized retailer/distributor or certified representative thereof or the Warranty will be void.
4. Malfunctions or failure resulting from misuse, abuse, negligence, alteration, accident, or lack of proper maintenance shall not be considered defects under the Warranty.
5. This Warranty applies only to components/systems for the care of poultry and livestock. Other applications in industry or commerce are not covered by this Warranty.
6. This Warranty applies only to the Original Purchaser of the product.

The **Seller/Manufacturer** shall not be liable for any **Consequential or Special Damage** which any purchaser may suffer or claim to suffer as a result of any defect in the product. **“Consequential” or “Special Damages”** as used herein include, but are not limited to, lost or damaged products or goods, costs of transportation, lost sales, lost orders, lost income, increased overhead, labor and incidental costs and operational inefficiencies.

THIS WARRANTY CONSTITUTES THE SELLER/MANUFACTURER’S ENTIRE AND SOLE WARRANTY AND THIS MANUFACTURER EXPRESSLY DISCLAIMS ANY AND ALL OTHER WARRANTIES, INCLUDING, BUT NOT LIMITED TO, EXPRESS AND IMPLIED WARRANTIES AS TO MERCHANTABILITY, FITNESS FOR PARTICULAR PURPOSES SOLD AND DESCRIPTION OR QUALITY OF THE PRODUCT FURNISHED HEREUNDER.

Hog Slat Retailers/Distributors are not authorized to modify or extend the terms and conditions of this Warranty in any manner or to offer or grant any other warranties for GrowerSelect products in addition to those terms expressly stated above. An officer of Hog Slat must authorize any exceptions to this Warranty in writing. The Seller/Manufacturer reserves the right to change models and specifications at any time without notice or obligation to improve previous models.

THIS PAGE IS INTENTIONALLY LEFT BLANK

This equipment must be installed in accordance with all State and Local Codes and applicable Regulations which should be followed in all cases. Authorities having jurisdiction should be consulted before installations are made.



**Hog Slat, Inc.
PO Box 300
Newton Grove, NC 28366**

Phone: (910) 594-0219

Fax: (910) 594-1392

www.hogslat.com

Copyright © 2014 by Hog Slat, Inc.

Part Number: HSMANUAL-041 Rev. A7
HSART-350
Market – Hog & Poultry